

# Bullet-proof steel door dw 64-1

## „Teckentrup BP“ Class FB4

(corresponds to Class M3 in accordance with German performance requirements)

Available with optional glazing in accordance with DIN EN 1063 - BR 4 (NS = shatter proof on the inside)



### Text example

Compile and tender according to requirements.

Please refer to technical data below for respective details.

Updated 1<sup>st</sup> June 2015

Position	No. of pieces	Item	Unit price €	Total price €
		dw 64-1 „Teckentrup BP“ FB4 bullet-proof single leaf steel door, double-skinned. Type of handing DIN right. Door leaf and frame galvanized and prime coated similar to RAL 9002 (Grey white), 64 mm thick, rebated on 3-sides. 2.0 mm thick corner frame with 3-sided seal and bottom sill. Mortice lock prepared for profile cylinder . 1 security bolt, 2 two-part KO hinges with ball bearings.		
		„Teckentrup“ or equivalent.		



### Technical data

<b>Product:</b>	Bullet-proof steel door dw 64-1 „Teckentrup BP“ FB4 Tested in accordance with DIN EN 1522 Class FB4	
<b>Installation in:</b>	<ul style="list-style-type: none"> <li>Masonry min. 240 mm</li> <li>Concrete min. 140 mm</li> </ul>	
<b>Dimensions:</b>	Width: 750 - 1500 mm	Height: 1750 - 3000 mm
<b>Type of handing:</b>	DIN right or DIN left	
<b>Door leaf:</b>	Double-skinned, thick rebated on 3 sides Filling: steel plate mineral wool gypsum board Door leaf thickness: 64 mm Sheet thickness: 1.5 mm Security bolt: 1	
<b>Frame:</b>	2.0 mm thick corner frame with 3-sided seal and bottom sill. Frame fixed with screws, 3 screws each side. Special equipment: block frame, counter frame or closed frame	
<b>Surface:</b>	Galvanized and prime-coated door leaf and frame (Grey white), similar to RAL 9002.	
<b>Hinges:</b>	<ul style="list-style-type: none"> <li>2 two-part KO hinges with ball bearings, secured hinge bolts.</li> </ul>	
<b>Fittings:</b>	<ul style="list-style-type: none"> <li>Mortice lock with latch lever, prepared for profile cylinder.</li> <li>Plastic handle set black. Handle pivoted on bearing with tumbler insert (Bb) and 1 Bb key.</li> </ul>	

**Glazing:** In accordance with DIN EN 1063 BR 4, glass thickness 49 mm with steel holding strips, NS shatter proof on the inside

**Special equipment:**

- Handle sets / Lever/Knob sets: (various makes) with fixed outer knob
- Locks
  - Profile cylinder 40.5 + 40.5 mm
  - Panic locks
- Floor seals
- Rectangular glazing (special size)
- Aluminum rain guard

#### Further qualifications (special equipment):



• **Fire resistant** tested as per EN 1342-1 (DIN 4102)



• **Sound insulated** as per DIN EN 20140/717-1 up to **Rw 45 dB**



• **Burglar-resistant** as per DIN EN 1627 - **RC 4**

# Bullet-proof steel door dw 64-1

## „Teckentrup BP“ Class FB4

(corresponds to Class M3 in accordance with German performance requirements)

Available with optional glazing in accordance with DIN EN 1063 - BR 4 (NS = shatter proof on the inside)

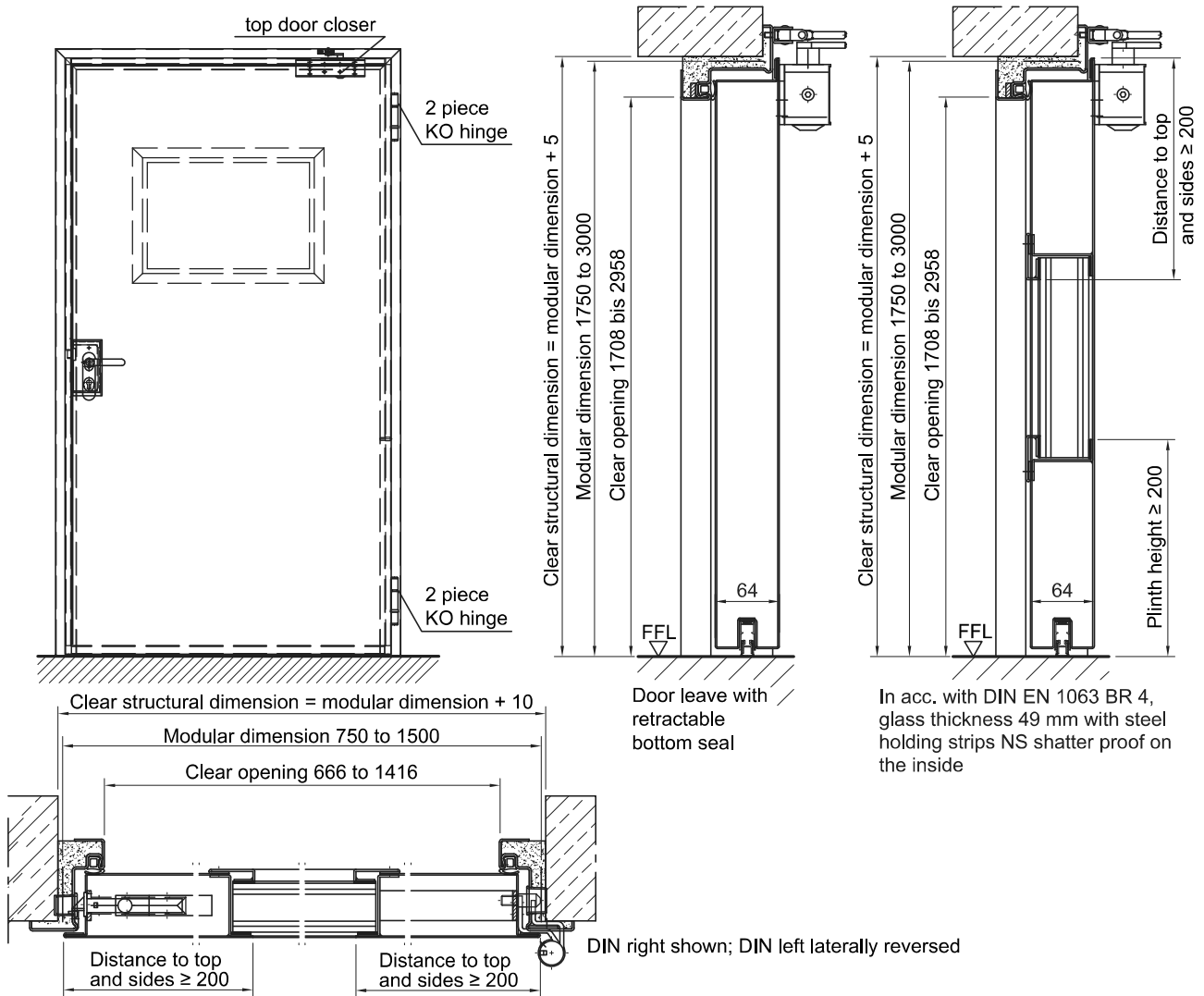

### Floor connections:

Image 1: with bottom buffer

Image 2: with bottom buffer/seal

Image 3: with bottom seal

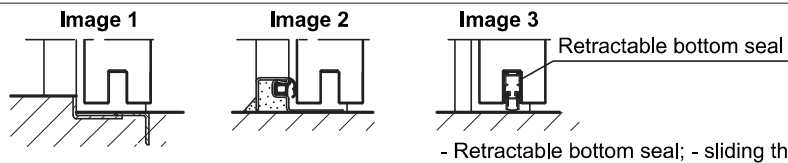

### Installation in masonry/ concrete walls

concrete walls  $\geq 140$  mm  
masonry walls  $\geq 240$  mm

Wall plug assembly

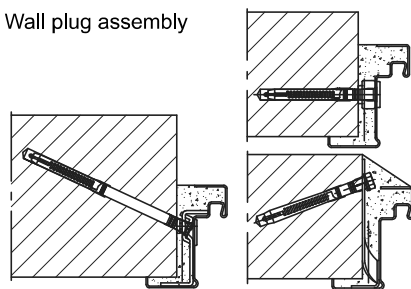

Wall plug assembly -  
closed frame  
and counter frame

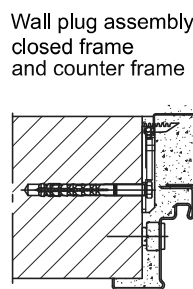

Anchor  
assembly

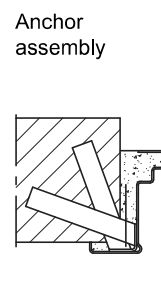

Weld-on  
assembly

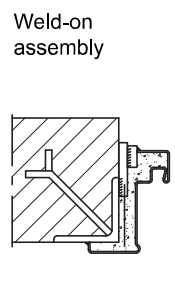

Installation in  
masonry/  
concrete walls  
flush installation  
between  
concrete walls  $\geq 140$  mm  
masonry walls  $\geq 240$  mm

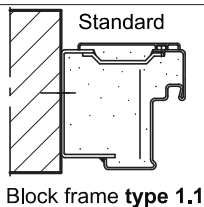

Block frame type 1.1